

Sevenstar D07-60 Series

Analog Mass Flow Controllers and Meters
Low Cost, High Flow, Viton sealed
300 slm – 2000 slm

esl 
service is solution



FEATURES

- ▶ **Cost Efficient**
- ▶ **High Accuracy**
±2.0% FS
- ▶ **Wide Flow Range**
300 slm ... 2000 slm
- ▶ **Suitable for High Inlet Pressure and Vacuum Applications**



The D07-60 mass flow controller/meter delivers high accuracy independent of pressure or temperature fluctuations and is designed for mass flow control applications covering the range from 300 slm to 2000 slm. It is especially well suited for the measurement and control of process gas in such semiconductor manufacturing applications as diffusion, oxidation, epitaxy, CVD, plasma sputtering and ion implantation. The D07-60 MFC/MFM operates at a variety of pressures and provides a high degree of reliability, ensuring repeatable low-drift performance over time. It offers soft-start, tightly controlled response and maximum application flexibility.

Performance

Accuracy	± 2.00% Fullscale
Linearity	± 1.00% Fullscale
Repeatability	± 0.20% Fullscale
Response Time	< 10.0 Seconds
Maximum Pressure	3.00 Mpa
Differential Pressure	0.25 ... 0.60 MPa
Temperature Range	5 ... 45°C
Valve Configuration	NC
Leak Integrity	1x10 ⁻⁸ atm.cc/sec He

Electrical

Connectors	SubD15
I/O Signal	0 ... 5 VDC
Power Supply	± 15 VDC

Materials

Wetted Materials	Stainless Steel 316L, Viton®
Seal Material	Viton®, Silicone Rubber, NBR, Teflon®
Weight	6.0 kg

Overall Length

1/2", 10MM LOK	272 mm
1/2" VCR / VCO Male	272 mm

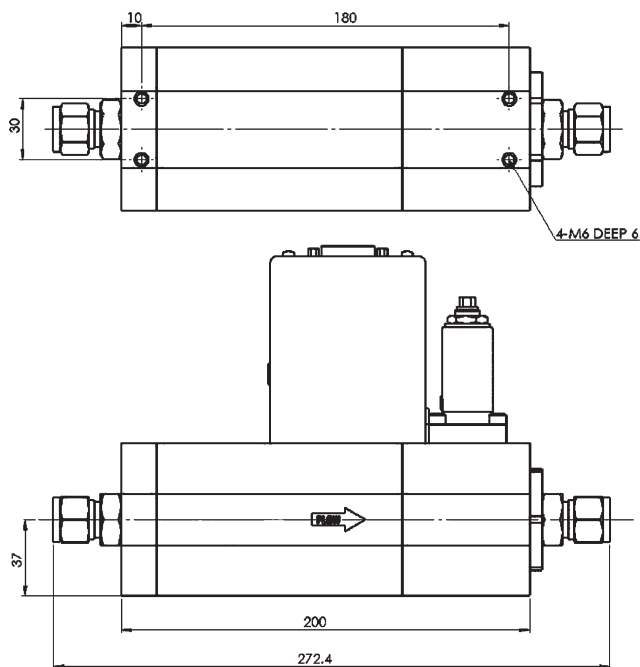

© ESL Elektronik GmbH is a ISO 9001 qualified supplier for semiconductor and other hitech equipment. Our calibrations are traceable to NIST and are performed in a class 100 cleanroom. Please contact our office for technical assistance.

ESL Elektronik GmbH • Lehnerstrasse 2 • 85630 Grasbrunn Germany • Tel.: +49-89-4207969-0 • Fax: +49-89-4207969-10
Email: info@esl-elektronik.de • www.esl-elektronik.de